

# Drain Vessels

## Drain Vessels

A common problem in many gas sample systems is removing liquids from a coalescing housing at low or negative pressure. By installing a drain vessel under the coalescing filter housing the liquid can be isolated for draining by the use of two valves.

The drain vessel can also be used to increase the volume of a coalescing filter housing to extend the service time.

Several sizes are available and there is a choice of stainless steel or Pyrex glass bowls. High pressure versions can also be manufactured.

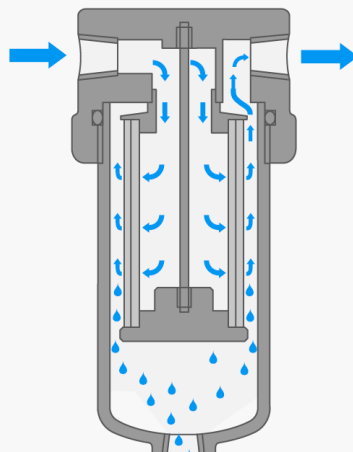
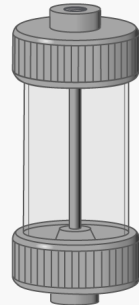

Valve A

Valve A is normally open to allow liquid to flow from the coalescing filter housing into the drain vessel.

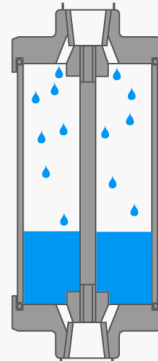

Valve B

Valve B is normally closed. When the drain vessel is full Valve A can be closed to isolate the drain vessel from the system. Valve B can then be opened to drain the liquid.

After the liquid has drained Valve B can be closed and Valve A opened.