

SG111 & SS112

Filter Housing

| | |
|------------------|----------------------------------|
| Materials | 316L SS & Pyrex Glass |
| Pressure | 100 & 150 psi |
| Ports | 1/8" or 1/4" |
| Element | 12.32.□ |

SG111 and SS112 series filter housings are specified for 1/8" & 1/4" line size applications at low pressure. For applications over 150 psi, the SS117 housings are available.

The housings are constructed from 316L stainless steel with a stainless steel or Pyrex glass bowl. The Pyrex bowl is also fitted with a bowl guard, this is not shown.

Standard housings have NPT ports and include Viton seals. Other seal types are available as an option. BSPT and BSPP port types are also available.

The housings are free from welds and comply with NACE MR-01-75 and conform to SEP of PED 2014/68/EU.

These housings can also be supplied in a wide range of exotic materials, such as Hastelloy, Monel, Titanium etc.

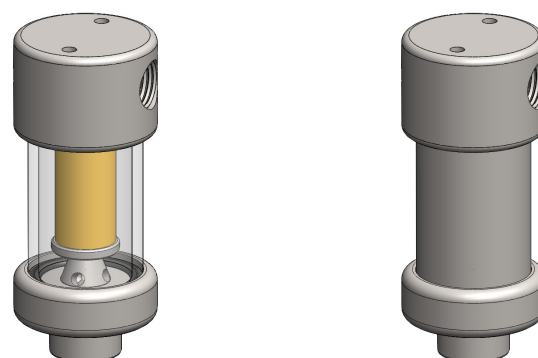

Bowl guard not shown

Technical Specifications

| Housing Model | SG111.111 | SG111.211 | SG111.221 | SS112.111 | SS112.211 | SS112.221 |
|---------------------------------------|-----------|-----------|-----------|-----------|-----------|-----------|
| Port Size | 1/8" NPT | 1/4" NPT | 1/4" NPT | 1/8" NPT | 1/4" NPT | 1/4" NPT |
| Drain | 1/8" NPT | 1/8" NPT | 1/4" NPT | 1/8" NPT | 1/8" NPT | 1/4" NPT |
| Maximum Pressure, psi (1) | 100 | 100 | 100 | 150 | 150 | 150 |
| Maximum Temperature, °F (2) | 210 | 210 | 210 | 210 | 390 | 390 |
| Materials of Construction (3) | | | | | | |
| Head & Internals | 316L SS | 316L SS | 316L SS | 316L SS | 316L SS | 316L SS |
| Bowl | Pyrex | Pyrex | Pyrex | 316L SS | 316L SS | 316L SS |
| Seals (4) | Viton | Viton | Viton | Viton | Viton | Viton |
| Filter Element Code (5) | 12.32.□ | 12.32.□ | 12.32.□ | 12.32.□ | 12.32.□ | 12.32.□ |
| Adsorber Cartridge Code (6) | 12.32.AD□ | 12.32.AD□ | 12.32.AD□ | 12.32.AD□ | 12.32.AD□ | 12.32.AD□ |
| Principle Dimensions in inches | | | | | | |
| Diameter | 1.55 | 1.55 | 1.55 | 1.55 | 1.55 | 1.55 |
| Height | 3.65 | 3.65 | 3.65 | 3.65 | 3.65 | 3.65 |
| Volume, cc | 25 | 25 | 25 | 25 | 25 | 25 |
| Weight, lbs | 0.90 | 0.90 | 0.90 | 0.90 | 0.90 | 0.90 |
| Accessories | | | | | | |
| Support Core | SC.SS11 | SC.SS11 | SC.SS11 | SC.SS11 | SC.SS11 | SC.SS11 |
| Mounting Bracket | MB.SS11 | MB.SS11 | MB.SS11 | MB.SS11 | MB.SS11 | MB.SS11 |

Notes

- (1) Above 390°F the pressure rating is reduced, consult us for the exact rating at any specific temperature (not SG types)
- (2) Maximum temperature is with standard seals. For temperatures up to 615°F use Chemraz seals
- (3) Material abbreviations, 316L SS = 316L Stainless Steel
- (4) Add suffix for other seal types, PTFE = .T, Chemraz = .C, Nitrile = N, Kalrez = .K, EPDM = .E, Silicone = .S, (e.g. SG111.221.T)
- (5) Replace the □ with the grade required, e.g. 12.32.5CK, 12.32.S20V, 12.32.T20
- (6) Replace the □ with the type required, e.g. 12.32.AD01



Contact Us

Classic Filters Ltd.
Sextant Park
Neptune Close
Rochester
Kent
England
ME2 4LU

T +44 (0)1634 724224
F +44 (0)1634 724234
E info@classicfilters.com
W www.classicfilters.com

Follow Us



<http://www.linkedin.com/company/classic-filters-ltd.>



<http://www.twitter.com/classicfilters>