

Materials 316L Stainless Steel
Pressure 3000 psi
Ports 1/4" or 1/2"
Element 25.64.□

SiS216 series filter housings with differential pressure indicators are specified for 3000 psi 1/4" line size and for 1/2" applications where response time must be kept short. If the flow rate or contamination is high, or where service intervals must be kept as long as possible, SiS236 series housings should be considered. For applications less than 1500 psi see the SiS215 series and for over 3000 psi see the SiS218 series.

Standard housings have NPT ports and Viton seals. Other seal types are available as an option. BSPT and BSPP port types are also available.

The housings are free from welds and comply with NACE MR-01-75 and are CE marked in accordance with PED 2014/68/EU.

These housings can also be supplied in a wide range of exotic materials, such as Hastelloy, Monel, Titanium etc.

See data sheet CF/2.1a/139 for more details about the DPI.

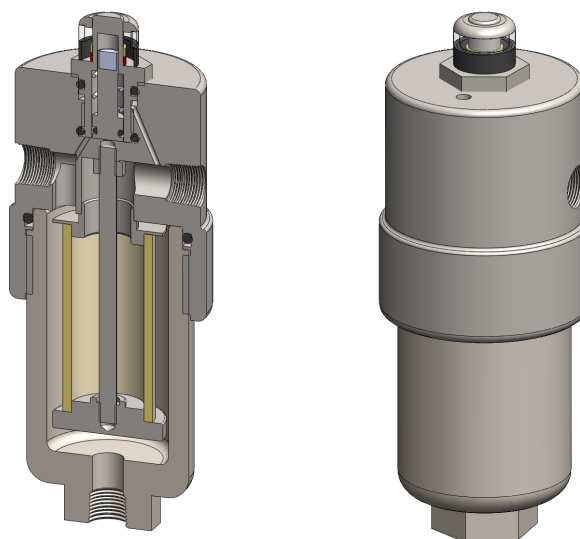

Technical Specifications

| Housing Model (1) | SiS216.201 | SiS216.221 | SiS216.401 | SiS216.421 | SiS216.441 |
|---------------------------------------|------------|------------|------------|------------|------------|
| Port Size | 1/4" NPT | 1/4" NPT | 1/2" NPT | 1/2" NPT | 1/2" NPT |
| Drain | None | 1/4" NPT | None | 1/4" NPT | 1/2" NPT |
| Maximum Pressure, psi | 3000 | 3000 | 3000 | 3000 | 3000 |
| Maximum Temperature, °F (2) | 200 | 200 | 200 | 200 | 200 |
| Materials of Construction (3) | | | | | |
| Head, Bowl & Internals | 316L SS | 316L SS | 316L SS | 316L SS | 316L SS |
| Magnet (4) | Neodymium | Neodymium | Neodymium | Neodymium | Neodymium |
| Cover | Acrylic | Acrylic | Acrylic | Acrylic | Acrylic |
| Seals (5) | Viton | Viton | Viton | Viton | Viton |
| Filter Element Code (6) | 25.64.□ | 25.64.□ | 25.64.□ | 25.64.□ | 25.64.□ |
| Principle Dimensions in inches | | | | | |
| Diameter | 2.50 | 2.50 | 2.50 | 2.50 | 2.50 |
| Height | 6.85 | 6.85 | 6.85 | 6.85 | 6.85 |
| Volume, cc | 120 | 120 | 120 | 120 | 120 |
| Weight, lbs | 5.70 | 5.70 | 5.70 | 5.70 | 5.70 |
| Accessories | | | | | |
| Support Core | SC.SS21 | SC.SS21 | SC.SS21 | SC.SS21 | SC.SS21 |
| Mounting Bracket | MBSiS21 | MBSiS21 | MBSiS21 | MBSiS21 | MBSiS21 |

Notes

- (1) Change part number to SeS216 for the electrical DPI version
- (2) Maximum temperature 200°F due to differential pressure indicator
- (3) Material abbreviations, 316L SS = 316L Stainless Steel
- (4) The magnet is electroplated with Ni-Cu-Ni
- (5) Add suffix for other seal types, Chemraz = .C, Nitrile = N, Kalrez = .K, EPDM = .E, Silicone = .S, (e.g. SiS216.221.E)
- (6) Replace the □ with the grade required, e.g. 25.64.5CK, 25.64.S20V, 25.64.T20



Contact Us

Classic Filters Ltd.
Sextant Park
Neptune Close
Rochester
Kent
England
ME2 4LU

T +44 (0)1634 724224
F +44 (0)1634 724234
E info@classicfilters.com
W www.classicfilters.com

Follow Us



<http://www.linkedin.com/company/classic-filters-ltd.>



<http://www.twitter.com/classicfilters>